

GMM 355 M 6a

GAMAK

شركة الأندلس التجارية
Al Andalos Trading Co

3-Phase 400 V (Δ) 50 Hz

Duty Type : S1

Degree of protection : IP 55 (TEFC)

Insulation class : F (155 °C)

Temp rise : Class B (80K)

Mounting Design : B3

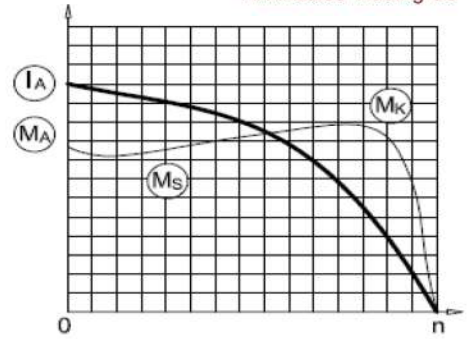

ELECTRICAL DESIGN

Direct On Line

Rated output (kW) : 160

Speed (rpm) : 990

Rated current (A) : 290

Torque – Mn (Nm) : 1543

Cos φ : 0.84

	4/4	3/4	1/2
Efficiency %	94.8	94.8	93.2

Moment of inertia J (kgm)² : 6.8

Locked rotor Current – Ia (A) : 2030

Ia / In : 7.0

Locked rotor Torque – Ma (Nm) : 3858

Ma / Mn : 2.5

Y / Δ Starting

Locked rotor Current – Ia (A) : 667

Ia / In : 2.3

Locked rotor Torque – Ma (Nm) : 1234

Ma / Mn : 0.8

Breakdown Torque – Mk (Nm) : 3703

Mk / Mn : 2.4

MECHANICAL DESIGN

Frame : Cast Iron
End shields : Cast Iron
Cooling fan : Plastic
Terminal box : Aluminium
Cable gland : M79
No of cable glands : 2

Bearing Arrangement

Standard design

Drive End

Non Drive End

6321 C3

6321 C3

Reinforced design

NU 321 E

6321 C3

Noise Level (dB-A) : 72

Paint : RAL 7031- Grey

Approximate weight (kg) : 1035

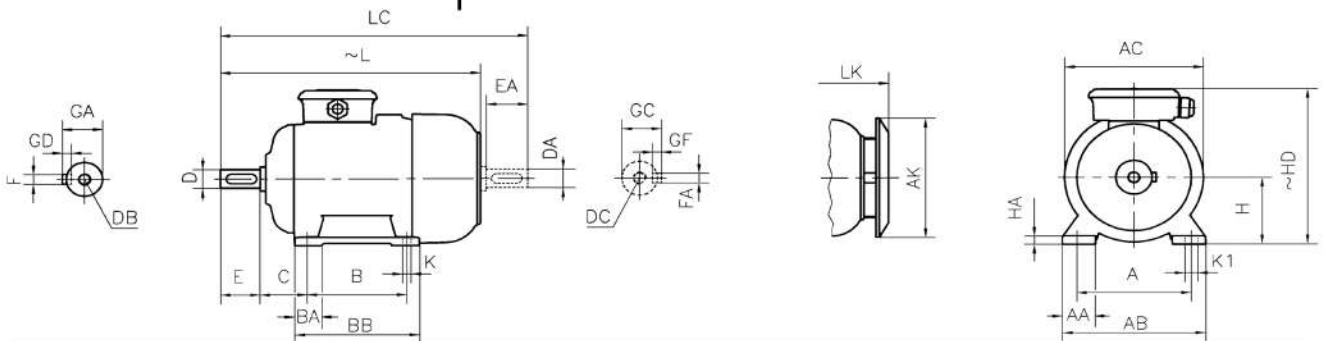

DIMENSIONS

Dimensions of foot mounted motors for mounting arrangement : B3, B6, B7, B8, B15, V5, V6

H	HD	HA	A	AA	AB	ØAC	ØAK	K	K1	B	B'	BA	BA'	BB	L	LC	LK	C	E	DB	ØD	GA	FxGD
	~														~		~		EA	DC	ØDA	GC	FAXGF
355	980	50	610	150	740	732	571	28	-	560	-	140	-	680	1377	1597	1454	254	210	M24	100	106	28X16

* Efficiencies are calculated according to indirect method where the additional load losses are determined from exact measurements at different load points.

contact:

Mob:00201022621584/00201092425789

Email:info@andalos-trading.com

website:www.andalos-trading.com

Egypt-Giza-of October City

Lelat Alqader-Almaged Center