

GM 315 M 6b

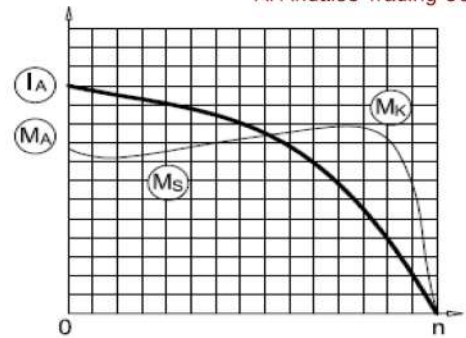

3-Phase 400 V (Δ) 50 Hz

- Duty Type : S1
- Degree of protection : IP 55 (TEFC)
- Insulation class : F (155 °C)
- Temp rise : Class B (80K)
- Mounting Design : B3



ELECTRICAL DESIGN

Direct On Line

- Rated output (kW) : 110
- Speed (rpm) : 990
- Rated current (A) : 198
- Torque – Mn (Nm) : 1061
- Cos φ : 0.85
- Efficiency % : 94.3 (4/4), 94.3 (3/4), 92.7 (1/2)

- Locked rotor Current – Ia (A) : 1386
- Ia / In : 7.0
- Locked rotor Torque – Ma (Nm) : 2653
- Ma / Mn : 2.5

Y / Δ Starting

Moment of inertia J (kgm)² : 3.5

- Locked rotor Current – Ia (A) : 455
- Ia / In : 2.3
- Locked rotor Torque – Ma (Nm) : 849
- Ma / Mn : 0.8
- Breakdown Torque – Mk (Nm) : 3183
- Mk / Mn : 3.0

MECHANICAL DESIGN

- Frame : Cast Iron
- End shields : Cast Iron
- Cooling fan : Plastic
- Terminal box : Aluminium
- Cable gland : Pg 48
- No of cable glands : 2

Bearing Arrangement

	Drive End	Non Drive End
Standard design	6318 C3	6318 C3
Reinforced design	NU 318 E	6318 C3
Noise Level (dB-A)	: 72	
Paint	: RAL 7031- Grey	
Approximate weight (kg)	: 860	

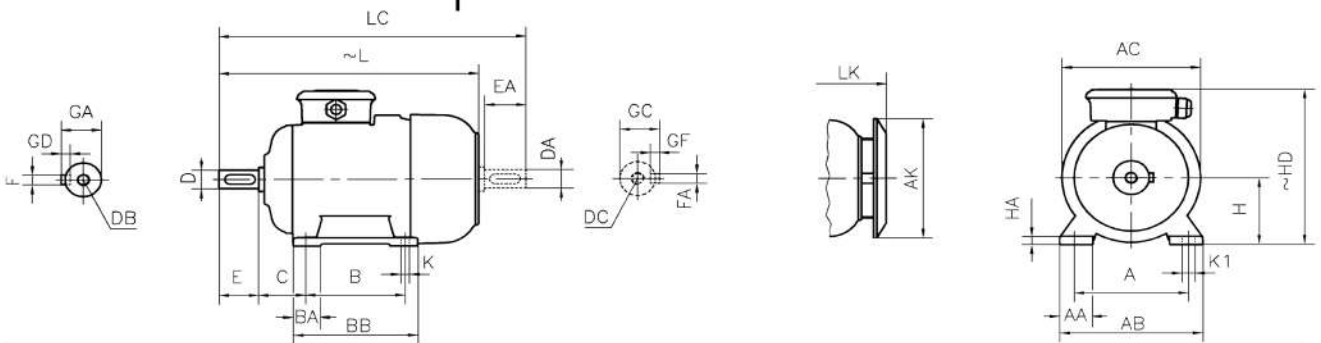

DIMENSIONS

Dimensions of foot mounted motors for mounting arrangement : B3, B6, B7, B8, B15, V5, V6

H	HD	HA	A	AA	AB	∅AC	∅AK	K	K1	B	B'	BA	BA'	BB	L	LC	LK	C	E	DB	∅D	GA	FxGD
315	825	50	508	125	620	614	51	28	-	-	457	115	166	550	1150	1330	1227	216	170	M20	85	90	22X14

* Efficiencies are calculated according to indirect method where the additional load losses are determined from exact measurements at different load points.

contact:

Mob:00201022621584/00201092425789

Email:info@andalos-trading.com

website:www.andalos-trading.com

Egypt-Giza-of October City
Lelat Alqader-Almaged Center