

GM 180 L 6

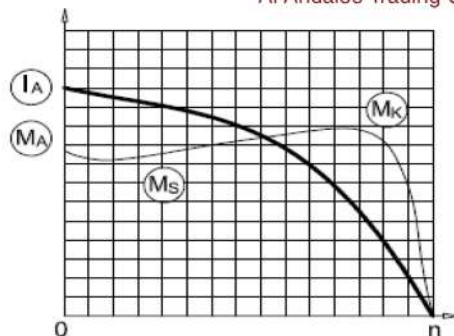

3-Phase 400 V (Δ) 50 Hz

- Duty Type : S1
- Degree of protection : IP 55 (TEFC)
- Insulation class : F (155 °C)
- Temp rise : Class B (80K)
- Mounting Design : B3



ELECTRICAL DESIGN

Direct On Line

Rated output (kW) : 15

Locked rotor Current – Ia (A) : 189

Ia / In : 6.5

Speed (rpm) : 965

Locked rotor Torque – Ma (Nm) : 355

Ma / Mn : 2.4

Rated current (A) : 29

Y / Δ Starting

Torque – Mn (Nm) : 148

Locked rotor Current – Ia (A) : 61

Ia / In : 2.1

Cos φ : 0.83

Locked rotor Torque – Ma (Nm) : 118

Ma / Mn : 0.8

	4/4	3/4	1/2
Efficiency %	: 89.7	89.7	86.8

Moment of inertia J (kgm)² : 0,20

Breakdown Torque – Mk (Nm) : 444

Mk / Mn : 3.0

MECHANICAL DESIGN

Bearing Arrangement

- Frame : Cast Iron
- End shields : Cast Iron
- Cooling fan : Plastic
- Terminal box : Plastic
- Cable gland : Pg 29
- No of cable glands : 2

	Drive End	Non Drive End
Standard design	6310 ZZ C3	6210 ZZ C3
Reinforced design	NU 310 E	6310 C3
Noise Level (dB-A)	: 62	
Paint	: RAL 7031- Grey	
Approximate weight (kg)	: 189	

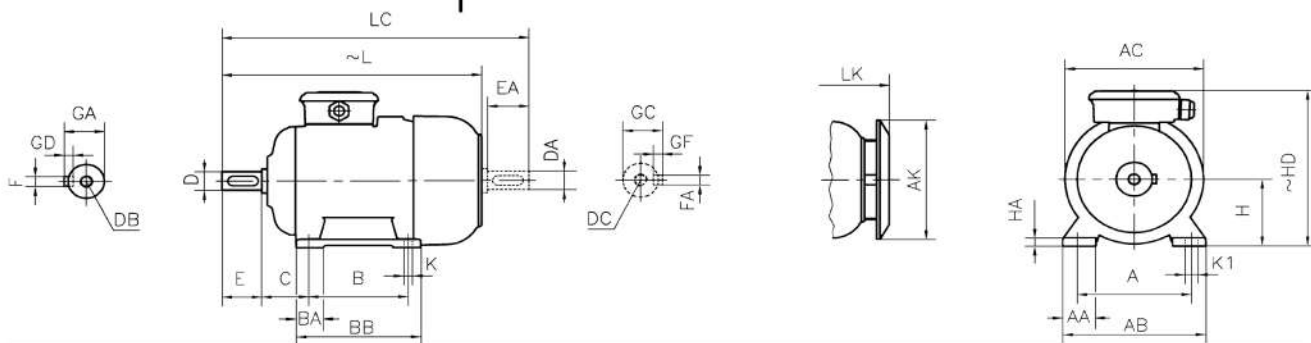

DIMENSIONS

Dimensions of foot mounted motors for mounting arrangement : B3, B6, B7, B8, B15, V5, V6

H	HD	HA	A	AA	AB	ØAC	ØAK	K	K1	B	B'	BA	BA'	BB	L	LC	LK	C	E	EA	DB	DC	ØD	ØDA	GA	GC	FxGD	FAXGF
180	421	24	279	68	354	348	303	15	-	279	-	62	-	329	695	811	752	121	110	M16	48	51.5	14X9					

* Efficiencies are calculated according to indirect method where the additional load losses are determined from exact measurements at different load points.

contact:

Mob:00201022621584/00201092425789

Email:info@andalos-trading.com

website:www.andalos-trading.com

Egypt-Giza-of October City

Lelat Alqader-Almaged Center