

AGM 132 M 6b

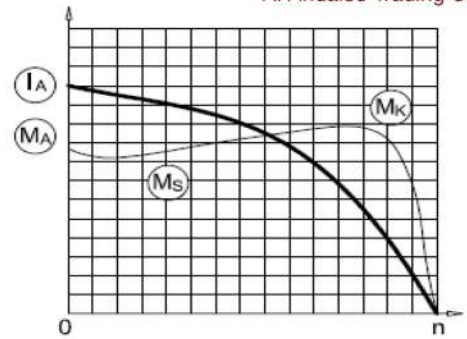

3-Phase 400 V (Δ) 50 Hz

- Duty Type : S1
- Degree of protection : IP 55 (TEFC)
- Insulation class : F (155 °C)
- Temp rise : Class B (80K)
- Mounting Design : B3



ELECTRICAL DESIGN

Direct On Line

Rated output (kW) : 5.5	Locked rotor Current – Ia (A) : 62
	Ia / In : 5.0
Speed (rpm) : 960	Locked rotor Torque – Ma (Nm) : 120
	Ma / Mn : 2.2
Rated current (A) : 12.3	
Torque – Mn (Nm) : 54.7	
Cos φ : 0.75	
Efficiency % : 86.0 3/4 1/2	
	Efficiency % : 86 83.1

Y / Δ Starting

Moment of inertia J (kgm) ² : 0.06	Locked rotor Current – Ia (A) : 20
	Ia / In : 1.6
	Locked rotor Torque – Ma (Nm) : 38
	Ma / Mn : 0.7
	Breakdown Torque – Mk (Nm) : 142
	Mk / Mn : 2.6

MECHANICAL DESIGN

- Frame : Aluminium
- End shields : Aluminium
- Cooling fan : Plastic
- Terminal box : Plastic
- Cable gland : Pg 21
- No of cable glands : 2

Bearing Arrangement

	Drive End	Non Drive End
Standard design	6208 ZZ	6208 ZZ
Reinforced design	NU 208 E	6028 C3
Noise Level (dB-A) : 61		
Paint : RAL 7031- Grey		
Approximate weight (kg) : 62		

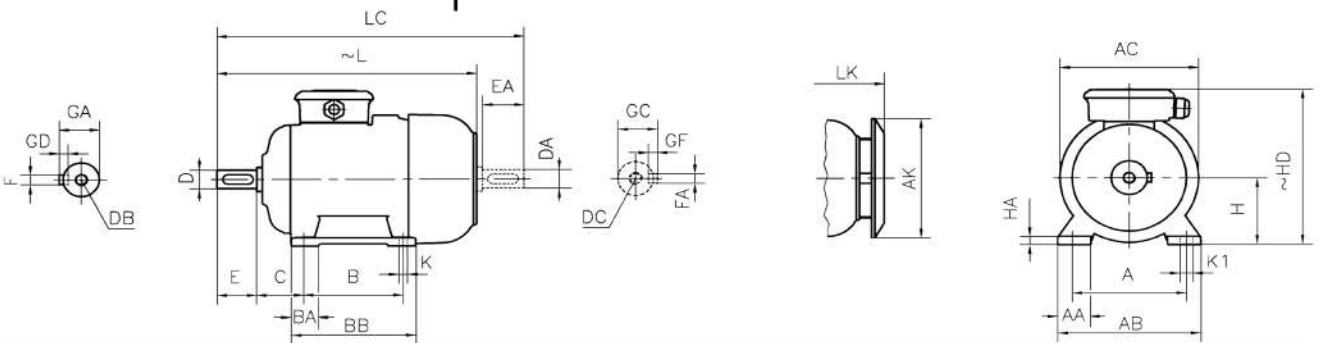

DIMENSIONS

Dimensions of foot mounted motors for mounting arrangement : B3, B6, B7, B8, B15, V5, V6

H	HD	HA	A	AA	AB	ØAC	ØAK	K	K1	B	B'	BA	BA'	BB	L	LC	LK	C	E	EA	DB	DC	ØDA	GA	GC	FxGD	FAXGF
132	300	15	216	49	260	257	239	12	18	178	-	46	-	218	523	614	560	89	80	M12	38	41	10X8				

* Efficiencies are calculated according to indirect method where the additional load losses are determined from exact measurements at different load points.

contact:

Mob:00201022621584/00201092425789

Email:info@andalos-trading.com

website:www.andalos-trading.com

Egypt-Giza-of October City

Lelat Alqader-Almaged Center