

AGM 132 S 6

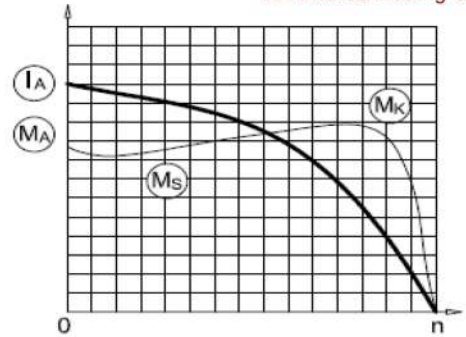

3-Phase 400 V (Δ) 50 Hz

- Duty Type : S1
- Degree of protection : IP 55 (TEFC)
- Insulation class : F (155 °C)
- Temp rise : Class B (80K)
- Mounting Design : B3



ELECTRICAL DESIGN

Direct On Line

Rated output (kW) : 3	Locked rotor Current – Ia (A) : 35
	Ia / In : 5.0
Speed (rpm) : 960	Locked rotor Torque – Ma (Nm) : 66
	Ma / Mn : 2.2
Rated current (A) : 6.9	
Torque – Mn (Nm) : 29.8	
Cos φ : 0.75	
Efficiency % : 83.3 83.2 80.4	

Y / Δ Starting

Moment of inertia J (kgm) ² : 0.028	Locked rotor Current – Ia (A) : 11
	Ia / In : 1.6
	Locked rotor Torque – Ma (Nm) : 21
	Ma / Mn : 0.7
	Breakdown Torque – Mk (Nm) : 77
	Mk / Mn : 2.6

MECHANICAL DESIGN

- Frame : Aluminium
- End shields : Aluminium
- Cooling fan : Plastic
- Terminal box : Plastic
- Cable gland : Pg 21
- No of cable glands : 2

Bearing Arrangement

	Drive End	Non Drive End
Standard design	6208 ZZ	6208 ZZ
Reinforced design	NU 208 E	6028 C3
Noise Level (dB-A) : 61		
Paint : RAL 7031- Grey		
Approximate weight (kg) : 44		

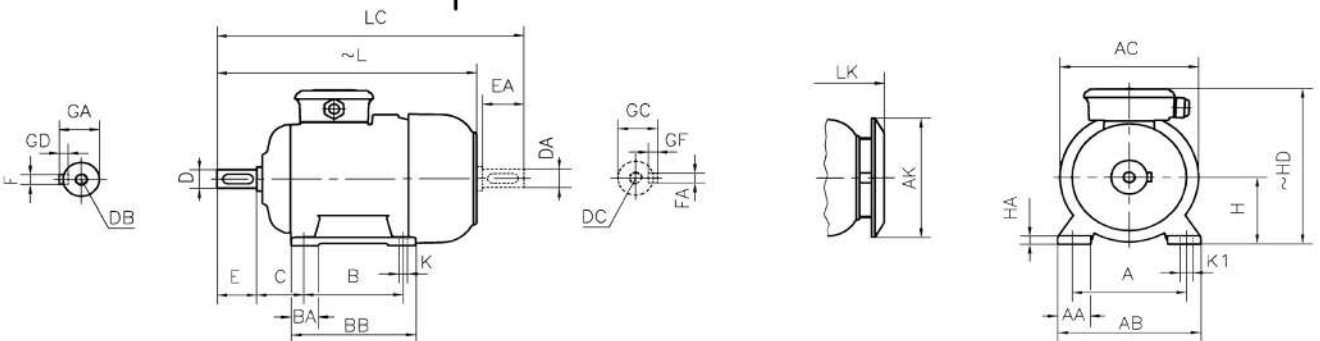

DIMENSIONS

Dimensions of foot mounted motors for mounting arrangement : B3, B6, B7, B8, B15, V5, V6

H	HD	HA	A	AA	AB	ØAC	ØAK	K	K1	B	B'	BA	BA'	BB	L	LC	LK	C	E	EA	DB	DC	ØD	ØDA	GA	GC	FxGD	FAXGF
132	300	15	216	49	260	257	239	12	18	140	-	46	-	180	460	546	497	89	80	M12	38	41	10X8					

* Efficiencies are calculated according to indirect method where the additional load losses are determined from exact measurements at different load points.

contact:

Mob:00201022621584/00201092425789

Email:info@andalos-trading.com

website:www.andalos-trading.com

Egypt-Giza-of October City

Lelat Alqader-Almaged Center