

AGM 90 L 6

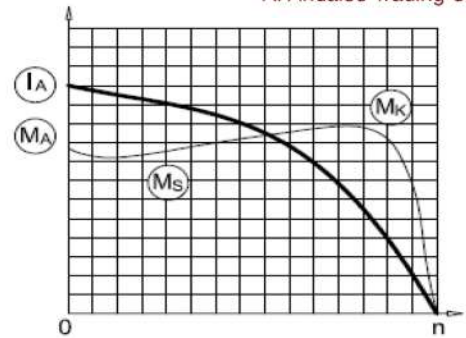

3-Phase 230/400 V 50 Hz

- Duty Type : S1
- Degree of protection : IP 55 (TEFC)
- Insulation class : F (155 °C)
- Temp rise : Class B (80K)
- Mounting Design : B3



ELECTRICAL DESIGN

Direct On Line

Rated output (kW)	: 1.1
Speed (rpm)	: 930
Rated current (A)	: 2.9
Torque – Mn (Nm)	: 11.3
Cos φ	: 0.70
Efficiency %	: 78.1 78.1 75.1

Locked rotor Current – Ia (A)	: 12
Ia / In	: 4.0
Locked rotor Torque – Ma (Nm)	: 25
Ma / Mn	: 2.2

Y / Δ Starting

Moment of inertia J (kgm)² : 0.0044

Locked rotor Current – Ia (A)	: -
Ia / In	: -
Locked rotor Torque – Ma (Nm)	: -
Ma / Mn	: -
Breakdown Torque – Mk (Nm)	: 27
Mk / Mn	: 2.4

MECHANICAL DESIGN

- Frame : Aluminium
- End shields : Aluminium
- Cooling fan : Plastic
- Terminal box : Plastic
- Cable gland : Pg 16
- No of cable glands : 1

Bearing Arrangement

	Drive End	Non Drive End
Standard design	6205 ZZ	6205 ZZ
Reinforced design	-	-
Noise Level (dB-A)	: 46	
Paint	: RAL 7031- Grey	
Approximate weight (kg)	: 14	

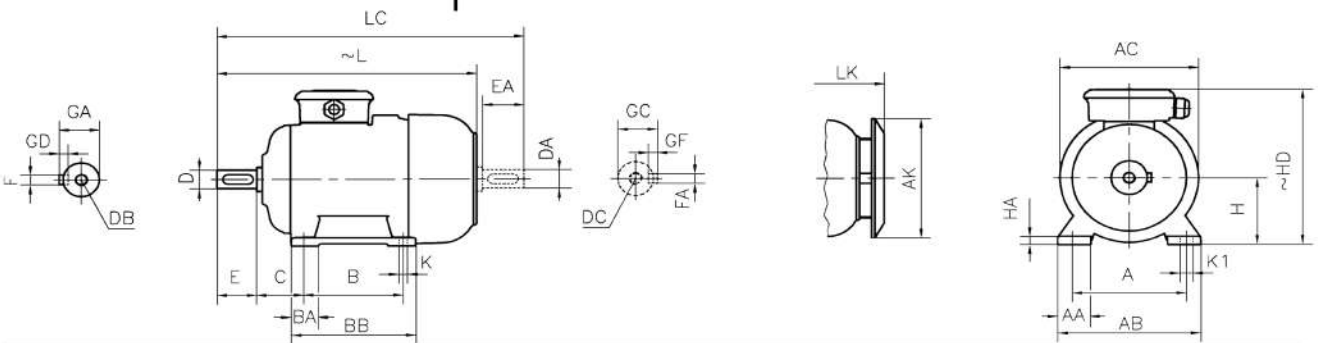

DIMENSIONS

Dimensions of foot mounted motors for mounting arrangement : B3, B6, B7, B8, B15, V5, V6

H	HD	HA	A	AA	AB	ØAC	ØAK	K	K1	B	B'	BA	BA'	BB	L	LC	LK	C	E	DB	ØD	GA	FxGD
~	~																	EA	DC	ØDA	GC	FAXGF	
90	216	12	140	43	180	176	151	10	15	125	-	35	-	155	334	389	363	56	50	M8	24	27	8X7

* Efficiencies are calculated according to indirect method where the additional load losses are determined from exact measurements at different load points.

contact:

Mob:00201022621584/00201092425789

Email:info@andalos-trading.com

website:www.andalos-trading.com

Egypt-Giza-of October City

Lelat Alqader-Almaged Center