

AGM 80 6a

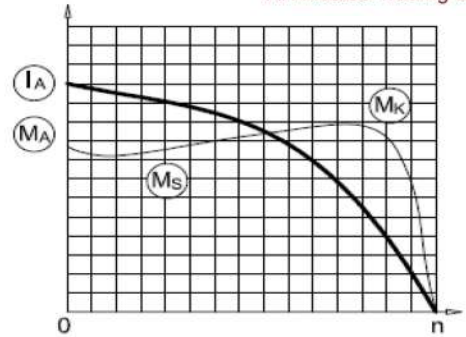

3-Phase 230/400 V 50 Hz

- Duty Type : S1
- Degree of protection : IP 55 (TEFC)
- Insulation class : F (155 °C)
- Temp rise : Class B (80K)
- Mounting Design : B3



ELECTRICAL DESIGN

Direct On Line

- Rated output (kW) : 0.37
- Speed (rpm) : 910
- Rated current (A) : 1.1
- Torque – Mn (Nm) : 3.88
- Cos φ : 0.67
- Efficiency % : 72.9 (4/4), 72.8 (3/4), 70.1 (1/2)
- Moment of inertia J (kgm)² : 0.0017

- Locked rotor Current – Ia (A) : 4
Ia / In : 3.6
- Locked rotor Torque – Ma (Nm) : 8
Ma / Mn : 2.1

Y / Δ Starting

- Locked rotor Current – Ia (A) : -
Ia / In : -
- Locked rotor Torque – Ma (Nm) : -
Ma / Mn : -
- Breakdown Torque – Mk (Nm) : 9
Mk / Mn : 2.4

MECHANICAL DESIGN

- Frame : Aluminium
- End shields : Aluminium
- Cooling fan : Plastic
- Terminal box : Plastic
- Cable gland : Pg 16
- No of cable glands : 1

Bearing Arrangement

	Drive End	Non Drive End
Standard design	6204 ZZ	6204 ZZ
Reinforced design	-	-
Noise Level (dB-A)	: 43	
Paint	: RAL 7031- Grey	
Approximate weight (kg)	: 8.1	

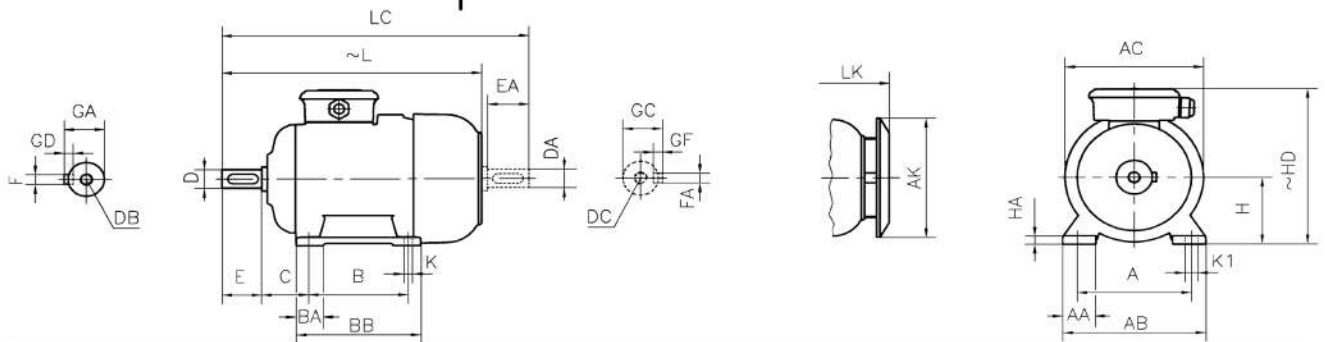

DIMENSIONS

Dimensions of foot mounted motors for mounting arrangement : B3, B6, B7, B8, B15, V5, V6

H	HD	HA	A	AA	AB	ØAC	ØAK	K	K1	B	B'	BA	BA'	BB	L	LC	LK	C	E	DB	ØD	GA	FxGD
~	~														~		~	EA	DC	ØDA	GC	FAXGF	
80	198	10	125	38	160	156	151	10	15	100	-	33	-	125	279	324	308	50	40	M6	19	21.5	6X6

* Efficiencies are calculated according to indirect method where the additional load losses are determined from exact measurements at different load points.

contact:

Mob:00201022621584/00201092425789

Email:info@andalos-trading.com

website:www.andalos-trading.com

Egypt-Giza-of October City

Lelat Alqader-Almaged Center