

# GMM 355 L 2b

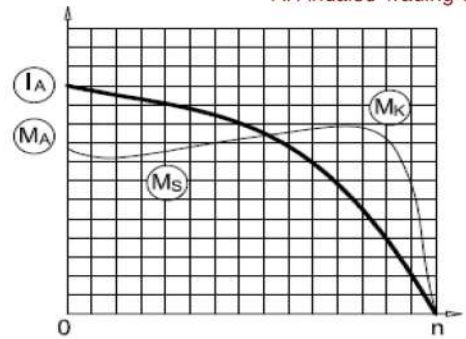

3-Phase 400 V (Δ) 50 Hz

- Duty Type : S1
- Degree of protection : IP 55 ( TEFC )
- Insulation class : F ( 155 °C )
- Temp rise : Class B ( 80K )
- Mounting Design : B3



## ELECTRICAL DESIGN

### Direct On Line

Rated output (kW) : 450	Locked rotor Current – Ia (A) : 5187
	Ia / In : 7.0
Speed (rpm) : 2980	Locked rotor Torque – Ma (Nm) : 2884
	Ma / Mn : 2.0
Rated current (A) : 741	
<b>Y / Δ Starting</b>	
Torque – Mn (Nm) : 1442	Locked rotor Current – Ia (A) : 1704
	Ia / In : 2.3
Cos φ : 0.92	Locked rotor Torque – Ma (Nm) : 865
	Ma / Mn : 0.6
Efficiency % : 95.2    95.2    93.8	Breakdown Torque – Mk (Nm) : 3749
	Mk / Mn : 2.6

Moment of inertia J (kgm)<sup>2</sup> : 5.3

## MECHANICAL DESIGN

- Frame : Cast Iron
- End shields : Cast Iron
- Cooling fan : Plastic
- Terminal box : Aluminium
- Cable gland : M79
- No of cable glands : 2

### Bearing Arrangement

	Drive End	Non Drive End
Standard design	6318 C3	6318 C3
Reinforced design	NU 318 E	6318 C3
Noise Level (dB-A)	: 79	
Paint	: RAL 7031- Grey	
Approximate weight (kg)	: 1630	

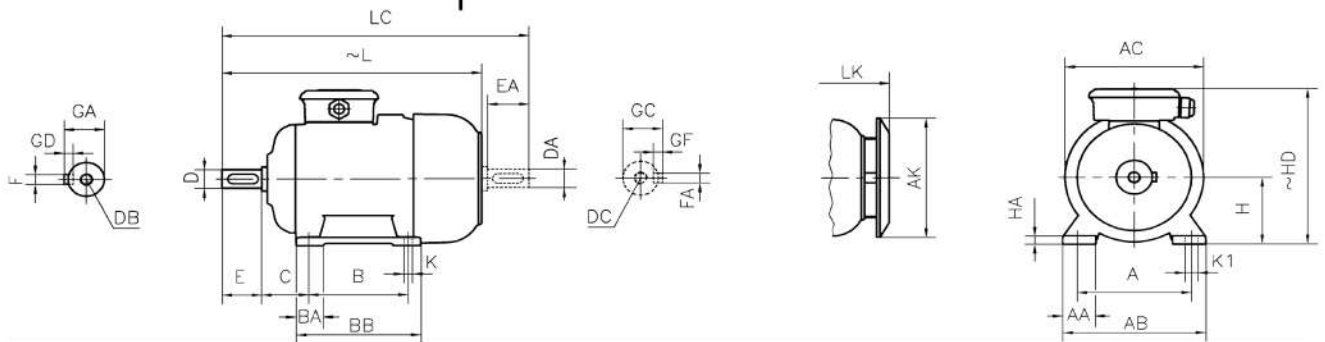

### DIMENSIONS

Dimensions of foot mounted motors for mounting arrangement : B3, B6, B7, B8, B15, V5, V6

H	HD	HA	A	AA	AB	ØAC	ØAK	K	K1	B	B'	BA	BA'	BB	L	LC	LK	C	E	EA	DB	DC	ØD	ØDA	GA	GC	FxGD	FAXGF
355	980	50	610	150	740	732	571	28	-	630	-	140	-	750	1467	1647	1544	254	170	M20	80	85	22X14					

\* Efficiencies are calculated according to indirect method where the additional load losses are determined from exact measurements at different load points.

contact:

Mob:00201022621584/00201092425789

Email:info@andalos-trading.com

website:www.andalos-trading.com

Egypt-Giza-of October City

Lelat Alqader-Almaged Center