

GM 315 M 2b

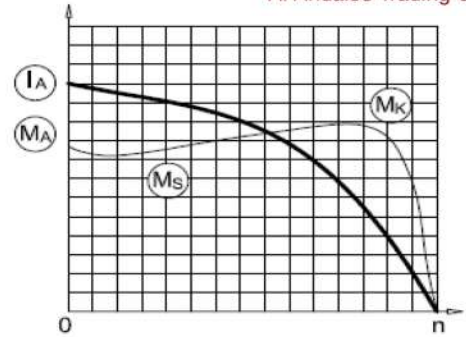

3-Phase 400 V (Δ) 50 Hz

- Duty Type : S1
- Degree of protection : IP 55 (TEFC)
- Insulation class : F (155 °C)
- Temp rise : Class B (80K)
- Mounting Design : B3



ELECTRICAL DESIGN

Direct On Line

Rated output (kW) : 160	Locked rotor Current – Ia (A) : 2075
	Ia / In : 7.8
Speed (rpm) : 2980	Locked rotor Torque – Ma (Nm) : 1283
	Ma / Mn : 2.5
Rated current (A) : 266	
Y / Δ Starting	
Torque – Mn (Nm) : 513	Locked rotor Current – Ia (A) : 692
	Ia / In : 2.6
Cos φ : 0.92	Locked rotor Torque – Ma (Nm) : 410
	Ma / Mn : 0.8
Efficiency % : 94.8 (4/4) 94.8 (3/4) 93.4 (1/2)	Breakdown Torque – Mk (Nm) : 1642
	Mk / Mn : 3.2

Moment of inertia J (kgm)² : 1.4

MECHANICAL DESIGN

- Frame : Cast Iron
- End shields : Cast Iron
- Cooling fan : Plastic
- Terminal box : Aluminium
- Cable gland : Pg 48
- No of cable glands : 2

Bearing Arrangement

	Drive End	Non Drive End
Standard design	6316 C3	6316 C3
Reinforced design	NU 316 E	6316 C3
Noise Level (dB-A)	: 79	
Paint	: RAL 7031- Grey	
Approximate weight (kg)	: 812	

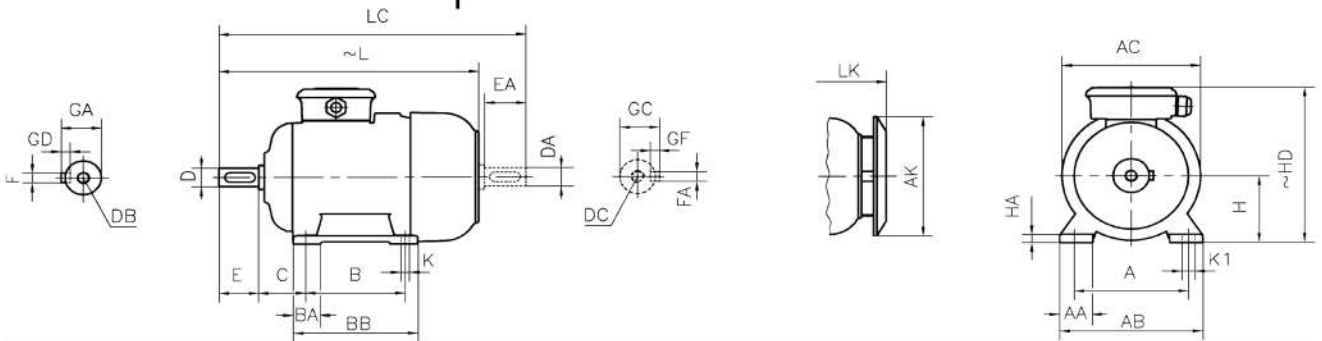

DIMENSIONS

Dimensions of foot mounted motors for mounting arrangement : B3, B6, B7, B8, B15, V5, V6

H	HD	HA	A	AA	AB	ØAC	ØAK	K	K1	B	B'	BA	BA'	BB	L	LC	LK	C	E	DB	ØD	GA	FxGD
	~														~		~	EA	DC	ØDA	GC	FAXGF	
315	825	50	508	125	620	614	571	28	-	-	457	115	166	550	1120	1270	1197	216	140	M20	65	69	18X11

* Efficiencies are calculated according to indirect method where the additional load losses are determined from exact measurements at different load points.

contact:

Mob:00201022621584/00201092425789

Email:info@andalos-trading.com

website:www.andalos-trading.com

Egypt-Giza-of October City

Lelat Alqader-Almaged Center