

GM 200 L 2b

3-Phase 400 V (Δ) 50 Hz

- Duty Type : S1
- Degree of protection : IP 55 (TEFC)
- Insulation class : F (155 °C)
- Temp rise : Class B (80K)
- Mounting Design : B3

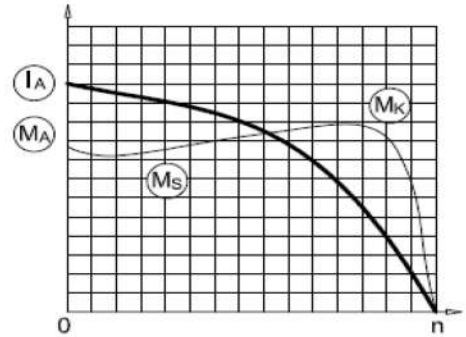

ELECTRICAL DESIGN

Direct On Line

Rated output (kW) : 37	Locked rotor Current – Ia (A) : 540
	Ia / In : 8.3
Speed (rpm) : 2970	Locked rotor Torque – Ma (Nm) : 321
	Ma / Mn : 2.7
Rated current (A) : 65	
Y / Δ Starting	
Torque – Mn (Nm) : 119	Locked rotor Current – Ia (A) : 176
	Ia / In : 2.7
Cos φ : 0.89	Locked rotor Torque – Ma (Nm) : 107
	Ma / Mn : 0.9
Efficiency % : 92.6 92.6 91.7	Breakdown Torque – Mk (Nm) : 357
	Mk / Mn : 3.0
Moment of inertia J (kgm) ² : 0.15	

MECHANICAL DESIGN

- Frame : Cast Iron
- End shields : Cast Iron
- Cooling fan : Plastic
- Terminal box : Aluminium
- Cable gland : Pg 36
- No of cable glands : 2

Bearing Arrangement

	Drive End	Non Drive End
Standard design	6312 ZZ C3	6212 ZZ C3
Reinforced design	NU 312 E	6312 C3
Noise Level (dB-A) : 73		
Paint : RAL 7031- Grey		
Approximate weight (kg) : 240		

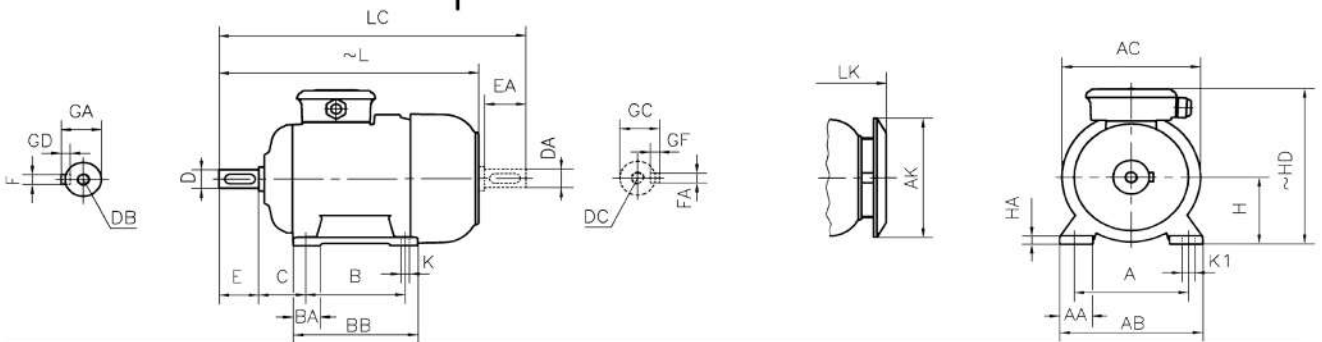

DIMENSIONS

Dimensions of foot mounted motors for mounting arrangement : B3, B6, B7, B8, B15, V5, V6

H	HD ~	HA	A	AA	AB	ØAC	ØAK	K	K1	B	B'	BA	BA'	BB	L ~	LC	LK ~	C	E EA	DB DC	ØD ØDA	GA GC	FxGD FAXGF
200	477	26	318	80	398	390	370	19	-	305	-	68	-	355	747	865	803	133	110	M20	55	59	16X10

* Efficiencies are calculated according to indirect method where the additional load losses are determined from exact measurements at different load points.

contact:

Mob:00201022621584/00201092425789

Email:info@andalos-trading.com

website:www.andalos-trading.com

Egypt-Giza-of October City

Lelat Alqader-Almaged Center