

AGM132 S 2a

GAMAK

شركة الأندلس التجارية
Al Andalus Trading Co

3-Phase 400 V (Δ) 50 Hz

Duty Type : S1
Degree of protection : IP 55 (TEFC)
Insulation class : F (155 °C)
Temp rise : Class B (80K)
Mounting Design : B3

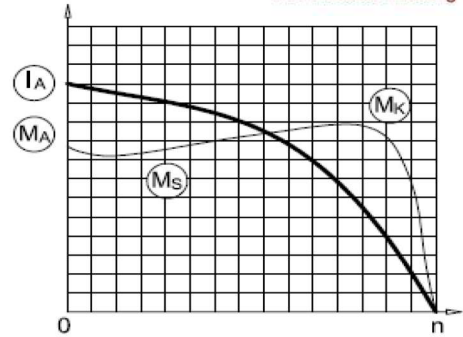

ELECTRICAL DESIGN

Direct On Line

Rated output (kW)	: 5.5	Locked rotor Current – Ia (A)	: 75
Speed (rpm)	: 2900	Ia / In	: 7.3
Rated current (A)	: 10.3	Locked rotor Torque – Ma (Nm)	: 51
		Ma / Mn	: 2.8
Torque – Mn (Nm)	: 18.1		
Cos φ	: 0.88		
	4/4 3/4 1/2		
Efficiency %	: 87.3 87.3 86.5		

Y / Δ Starting

		Locked rotor Current – Ia (A)	: 25
		Ia / In	: 2.4
		Locked rotor Torque – Ma (Nm)	: 16
		Ma / Mn	: 0.9
Moment of inertia J (kgm) ²	: 0.0108	Breakdown Torque – Mk (Nm)	: 63
		Mk / Mn	: 3.5

MECHANICAL DESIGN

Frame : Aluminium
End shields : Aluminium
Cooling fan : Plastic
Terminal box : Plastic
Cable gland : Pg 21
No of cable glands : 2

Bearing Arrangement

	Drive End	Non Drive End
Standard design	6208 ZZ	6208 ZZ
Reinforced design	NU 208 E	6028 C3
Noise Level (dB-A)	: 66	
Paint	: RAL 7031- Grey	
Approximate weight (kg)	: 37	

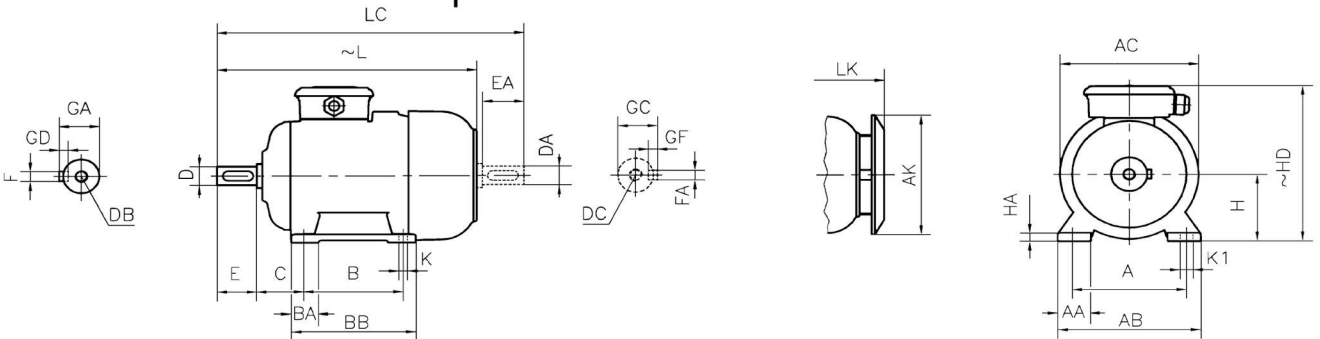

DIMENSIONS

Dimensions of foot mounted motors for mounting arrangement : B3, B6, B7, B8, B15, V5, V6

H	HD	HA	A	AA	AB	ØAC	ØAK	K	K1	B	B'	BA	BA'	BB	L	LC	LK	C	E	EA	DB	DC	ØD	ØDA	GA	GC	FxGD	FAXGF	
132	300	15	216	49	260	257	239	12	18	140	-	46	-	180	460	546	497	89	80	M12	38	41	10X8						

* Efficiencies are calculated according to indirect method where the additional load losses are determined from exact measurements at different load points.

contact:

Mob:00201022621584/00201092425789

Email:info@andalos-trading.com

website:www.andalos-trading.com

Egypt-Giza-of October City

Lelat Alqader-Almaged Center