

AGM 80 2a

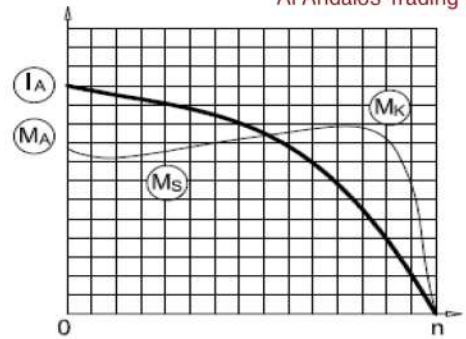

3-Phase 230/400 V 50 Hz

- Duty Type : S1
- Degree of protection : IP 55 (TEFC)
- Insulation class : F (155 °C)
- Temp rise : Class B (80K)
- Mounting Design : B3



ELECTRICAL DESIGN

Direct On Line

Rated output (kW) : 1.5	Locked rotor Current – Ia (A) : 21
	Ia / In : 6.3
Speed (rpm) : 2880	Locked rotor Torque – Ma (Nm) : 11
	Ma / Mn : 2.3
Rated current (A) : 3.3	
Torque – Mn (Nm) : 4.97	
Cos φ : 0.80	
Efficiency % : 82.0 82 80.1	
Moment of inertia J (kgm) ² : 0.0011	Breakdown Torque – Mk (Nm) : 15
	Mk / Mn : 3.0

Y / Δ Starting

Locked rotor Current – Ia (A) : -
Ia / In : -
Locked rotor Torque – Ma (Nm) : -
Ma / Mn : -
Breakdown Torque – Mk (Nm) : 15
Mk / Mn : 3.0

MECHANICAL DESIGN

- Frame : Aluminium
- End shields : Aluminium
- Cooling fan : Plastic
- Terminal box : Plastic
- Cable gland : Pg 16
- No of cable glands : 1

Bearing Arrangement

	Drive End	Non Drive End
Standard design	6205 ZZ	6205 ZZ
Reinforced design	-	-
Noise Level (dB-A) : 61		
Paint : RAL 7031- Grey		
Approximate weight (kg) : 11.5		

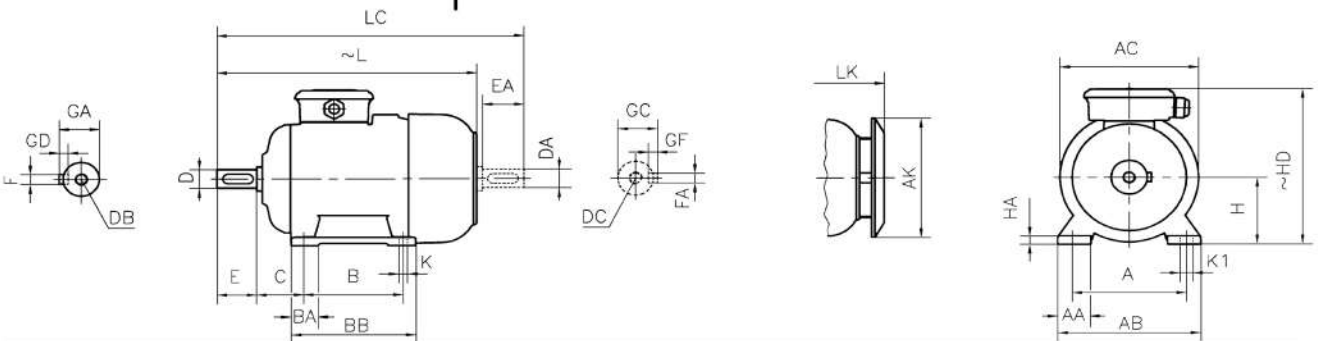

DIMENSIONS

Dimensions of foot mounted motors for mounting arrangement : B3, B6, B7, B8, B15, V5, V6

H	HD	HA	A	AA	AB	ØAC	ØAK	K	K1	B	B'	BA	BA'	BB	L	LC	LK	C	E	DB	ØD	GA	FxGD
~	~																	EA	DC	ØDA	GC	FAXGF	
90	216	12	140	43	180	176	151	10	15	100	-	35	-	130	309	364	338	56	50	M8	24	27	8X7

contact:

Mob:00201022621584/00201092425789

Email:info@andalos-trading.com

website:www.andalos-trading.com

Egypt-Giza-of October City

Lelat Alqader-Almaged Center