

AGM80 2b

3-Phase 230/400 V 50 Hz

- Duty Type : S1
- Degree of protection : IP 55 (TEFC)
- Insulation class : F (155 °C)
- Temp rise : Class B (80K)
- Mounting Design : B3

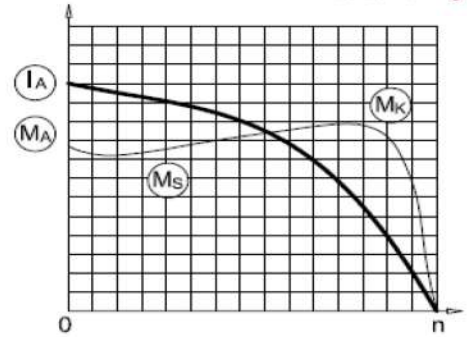

ELECTRICAL DESIGN

Direct On Line

Rated output (kW)	: 1.1
Speed (rpm)	: 2900
Rated current (A)	: 2.3
Torque – Mn (Nm)	: 3.62
Cos φ	: 0.83
Efficiency %	4/4 : 82.7
	3/4 : 82.5
	1/2 : 80.6
Moment of inertia J (kgm) ²	: 0.0008

Locked rotor Current – Ia (A)	: 14
Ia / In	: 5.9
Locked rotor Torque – Ma (Nm)	: 9
Ma / Mn	: 2.6

Y / Δ Starting

Locked rotor Current – Ia (A)	: -
Ia / In	: -
Locked rotor Torque – Ma (Nm)	: -
Ma / Mn	: -
Breakdown Torque – Mk (Nm)	: 13
Mk / Mn	: 3.7

MECHANICAL DESIGN

- Frame : Aluminium
- End shields : Aluminium
- Cooling fan : Plastic
- Terminal box : Plastic
- Cable gland : Pg 16
- No of cable glands : 1

Bearing Arrangement

	Drive End	Non Drive End
Standard design	6204 ZZ	6204 ZZ
Reinforced design	-	-
Noise Level (dB-A)	: 54	
Paint	: RAL 7031- Grey	
Approximate weight (kg)	: 10.4	

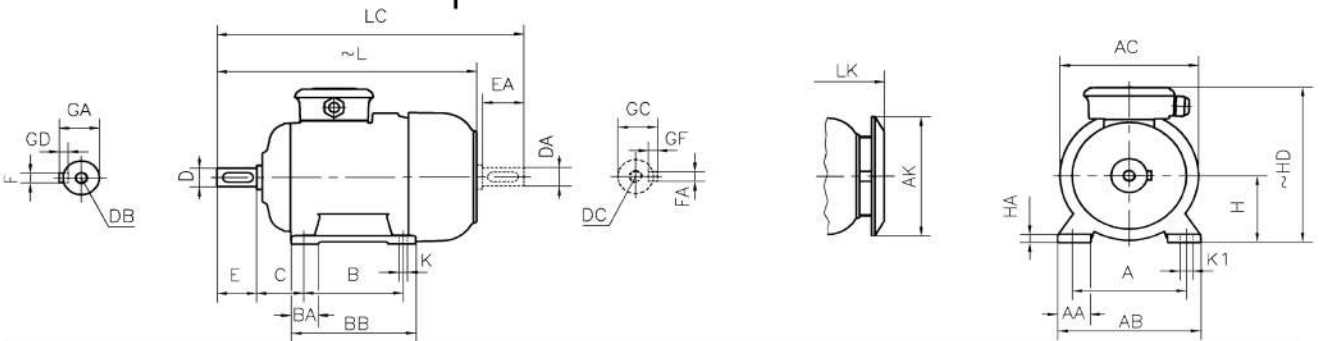

DIMENSIONS

Dimensions of foot mounted motors for mounting arrangement : B3, B6, B7, B8, B15, V5, V6

H	HD	HA	A	AA	AB	ØAC	ØAK	K	K1	B	B'	BA	BA'	BB	L	LC	LK	C	E	DB	ØD	GA	FxGD
~	~														~		~	EA	DC	ØDA	GC	FAXGF	
80	198	10	125	38	160	156	151	10	15	100	-	33	-	125	279	324	308	50	40	M6	19	21.5	6X6

* Efficiencies are calculated according to indirect method where the additional load losses are determined from exact measurements at different load points.

contact:

Mob:00201022621584/00201092425789

Email:info@andalos-trading.com

website:www.andalos-trading.com

Egypt-Giza-of October City

Lelat Alqader-Almaged Center