

AGM 63 2b

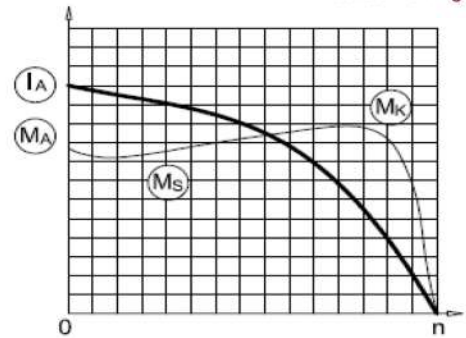

3-Phase 230/400 V 50 Hz

- Duty Type : S1
- Degree of protection : IP 55 (TEFC)
- Insulation class : F (155 °C)
- Temp rise : Class B (80K)
- Mounting Design : B3



ELECTRICAL DESIGN

Direct On Line

Rated output (kW)	: 0.25
Speed (rpm)	: 2840
Rated current (A)	: 0.67
Torque – Mn (Nm)	: 0.84
Cos φ	: 0.80
Efficiency %	: 67.3 67.1 60.9

Locked rotor Current – Ia (A)	: 3
Ia / In	: 4.5
Locked rotor Torque – Ma (Nm)	: 2
Ma / Mn	: 2.5

Y / Δ Starting

Moment of inertia J (kgm)² : 0.00013

Locked rotor Current – Ia (A)	: -
Ia / In	: -
Locked rotor Torque – Ma (Nm)	: -
Ma / Mn	: -
Breakdown Torque – Mk (Nm)	: 2
Mk / Mn	: 2.9

MECHANICAL DESIGN

- Frame : Aluminium
- End shields : Aluminium
- Cooling fan : Plastic
- Terminal box : Plastic
- Cable gland : Pg 11
- No of cable glands : 1

Bearing Arrangement

	Drive End	Non Drive End
Standard design	6201 ZZ	6201 ZZ
Reinforced design	-	-
Noise Level (dB-A)	: 52	
Paint	: RAL 7031- Grey	
Approximate weight (kg)	: 4	

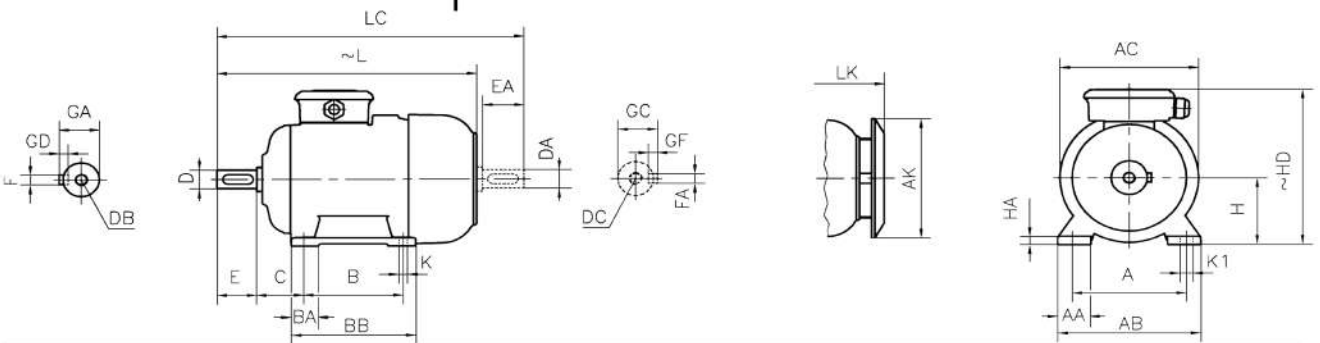

DIMENSIONS

Dimensions of foot mounted motors for mounting arrangement : B3, B6, B7, B8, B15, V5, V6

H	HD	HA	A	AA	AB	ØAC	ØAK	K	K1	B	B'	BA	BA'	BB	L	LC	LK	C	E	EA	DB	DC	ØD	ØDA	GA	GC	FxGD	FAXGF
63	160	10	100	31	125	121	116	7	11	80	-	27	-	103	216	243	245	40	23	M4	M4	11	12.5	12.5	12.5	4X4	4X4	

* Efficiencies are calculated according to indirect method where the additional load losses are determined from exact measurements at different load points.

contact:

Mob:00201022621584/00201092425789

Email:info@andalos-trading.com

website:www.andalos-trading.com

Egypt-Giza-of October City

Lelat Alqader-Almaged Center