

AGM 56 2b

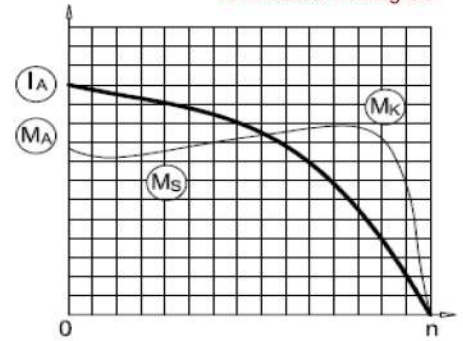

3-Phase 230/400 V 50 Hz

- Duty Type : S1
- Degree of protection : IP 55 (TEFC)
- Insulation class : F (155 °C)
- Temp rise : Class B (80K)
- Mounting Design : B3



ELECTRICAL DESIGN

Direct On Line

Rated output (kW) : 0.12

Locked rotor Current – Ia (A) : 1
Ia / In : 4.2

Speed (rpm) : 2800

Locked rotor Torque – Ma (Nm) : 1
Ma / Mn : 2.5

Rated current (A) : 0.35

Y / Δ Starting

Torque – Mn (Nm) : 0.41

Locked rotor Current – Ia (A) : -
Ia / In : -

Cos φ : 0.77

Locked rotor Torque – Ma (Nm) : -
Ma / Mn : -

	4/4	3/4	1/2
Efficiency %	64.5	64.1	56.9

Moment of inertia J (kgm)² : 0.00012

Breakdown Torque – Mk (Nm) : 1
Mk / Mn : 2.8

MECHANICAL DESIGN

- Frame : Aluminium
- End shields : Aluminium
- Cooling fan : Plastic
- Terminal box : Plastic
- Cable gland : Pg 11
- No of cable glands : 1

Bearing Arrangement

Standard design

Drive End

6200 ZZ

Non Drive End

6200 ZZ

Reinforced design

-

-

Noise Level (dB-A) : 42

Paint : RAL 7031- Grey

Approximate weight (kg) : 2.8

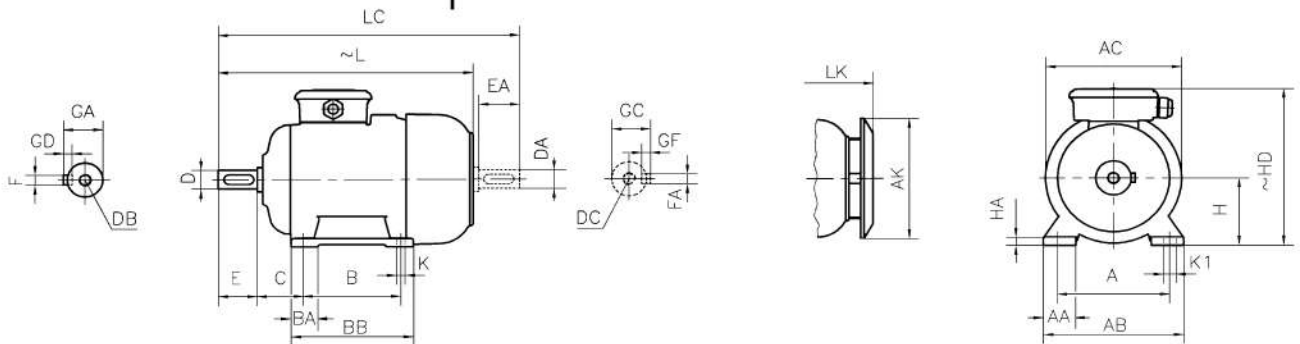

DIMENSIONS

Dimensions of foot mounted motors for mounting arrangement : B3, B6, B7, B8, B15, V5, V6

H	HD	HA	A	AA	AB	ØAC	ØAK	K	K1	B	B'	BA	BA'	BB	L	LC	LK	C	E	EA	DB	DC	ØD	GA	GC	FxGD
56	152	9	90	28	112	105	-	5.8	9	71	-	24	-	87	161	185	-	36	20	M4	9	10.2	3X3			

* Efficiencies are calculated according to indirect method where the additional load losses are determined from exact measurements at different load points.

contact:

Mob:00201022621584/00201092425789

Email:andaloseg@gmail.com

website:www.andalos-trading.com

Egypt-Giza-of October City

Lelat Alqader-Almaged Center