

## GMM 355 M 4a

3-Phase 400 V (Δ) 50 Hz

Duty Type : S1

Degree of protection : IP 55 ( TEFC )

Insulation class : F ( 155 °C )

Temp rise : Class B ( 80K )

Mounting Design : B3

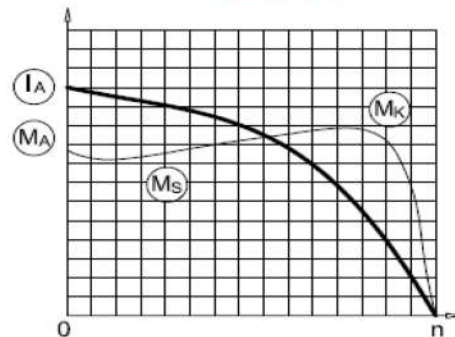

## ELECTRICAL DESIGN

## Direct On Line

Rated output (kW) : 250

Speed (rpm) : 1485

Rated current (A) : 430

Torque – Mn (Nm) : 1608

Cos φ : 0.88

	4/4	3/4	1/2
Efficiency %	: 95.1	95.1	94.2

Moment of inertia J (kgm)<sup>2</sup> : 5.5

Locked rotor Current – I<sub>a</sub> (A) : 3010

I<sub>a</sub> / I<sub>n</sub> : 7.0

Locked rotor Torque – M<sub>a</sub> (Nm) : 3216

M<sub>a</sub> / M<sub>n</sub> : 2.0

## Y / Δ Starting

Locked rotor Current – I<sub>a</sub> (A) : 989

I<sub>a</sub> / I<sub>n</sub> : 2.3

Locked rotor Torque – M<sub>a</sub> (Nm) : 965

M<sub>a</sub> / M<sub>n</sub> : 0.6

Breakdown Torque – M<sub>k</sub> (Nm) : 4502

M<sub>k</sub> / M<sub>n</sub> : 2.8

## MECHANICAL DESIGN

Frame : Cast Iron  
End shields : Cast Iron  
Cooling fan : Plastic  
Terminal box : Aluminium  
Cable gland : M79  
No of cable glands : 2

## Bearing Arrangement

Standard design

Drive End

6321 C3

Non Drive End

6321 C3

Reinforced design

NU 321 E

6321 C3

Noise Level (dB-A) : 75

Paint : RAL 7031- Grey

Approximate weight (kg) : 1378

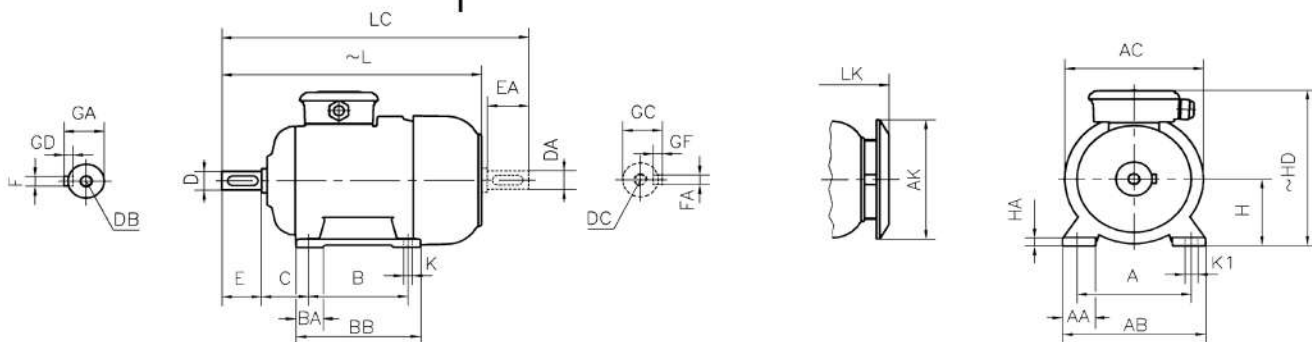

## DIMENSIONS

### Dimensions of foot mounted motors for mounting arrangement : B3, B6, B7, B8, B15, V5, V6

H	HD	HA	A	AA	AB	ØAC	ØAK	K	K1	B	B'	BA	BA'	BB	L	LC	LK	C	E	EA	DB	DC	ØD	ØDA	GA	GC	FxGD	FAXGF
355	980	50	610	150	740	732	571	28	-	560	-	140	-	680	1377	1597	1454	254	210	M24	100	106	28X16					

\* Efficiencies are calculated according to indirect method where the additional load losses are determined from exact measurements at different load points.

contact:

Mob:00201022621584/00201092425789

Email:info@andalos-trading.com

website:www.andalos-trading.com

Egypt-Giza-of October City

Lelat Alqader-Almaged Center