

# GM 180 L 4

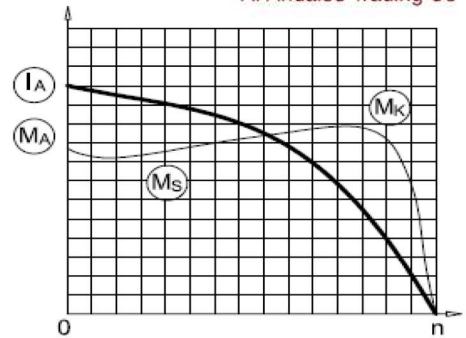

3-Phase 400 V (Δ) 50 Hz

- Duty Type : S1
- Degree of protection : IP 55 ( TEFC )
- Insulation class : F ( 155 °C )
- Temp rise : Class B ( 80K )
- Mounting Design : B3



## ELECTRICAL DESIGN

### Direct On Line

Rated output (kW) : 22	Locked rotor Current – I <sub>a</sub> (A) : 353
Speed (rpm) : 1470	I <sub>a</sub> / I <sub>n</sub> : 8.3
Rated current (A) : 42.5	Locked rotor Torque – M <sub>a</sub> (Nm) : 386
Torque – M <sub>n</sub> (Nm) : 143	M <sub>a</sub> / M <sub>n</sub> : 2.7
Cos φ : 0.82	
Efficiency % : 91.7 (4/4) 91.7 (3/4) 90.6 (1/2)	
Moment of inertia J (kgm) <sup>2</sup> : 0.15	Locked rotor Current – I <sub>a</sub> (A) : 115
	I <sub>a</sub> / I <sub>n</sub> : 2.7
	Locked rotor Torque – M <sub>a</sub> (Nm) : 172
	M <sub>a</sub> / M <sub>n</sub> : 1.2
	Breakdown Torque – M <sub>k</sub> (Nm) : 543
	M <sub>k</sub> / M <sub>n</sub> : 3.8

### Y / Δ Starting

## MECHANICAL DESIGN

- Frame : Cast Iron
- End shields : Cast Iron
- Cooling fan : Plastic
- Terminal box : Plastic
- Cable gland : Pg 29
- No of cable glands : 2

### Bearing Arrangement

	Drive End	Non Drive End
Standard design	6310 ZZ C3	6210 ZZ C3
Reinforced design	NU 310 E	6310 C3
Noise Level (dB-A)	: 64	
Paint	: RAL 7031- Grey	
Approximate weight (kg)	: 180	

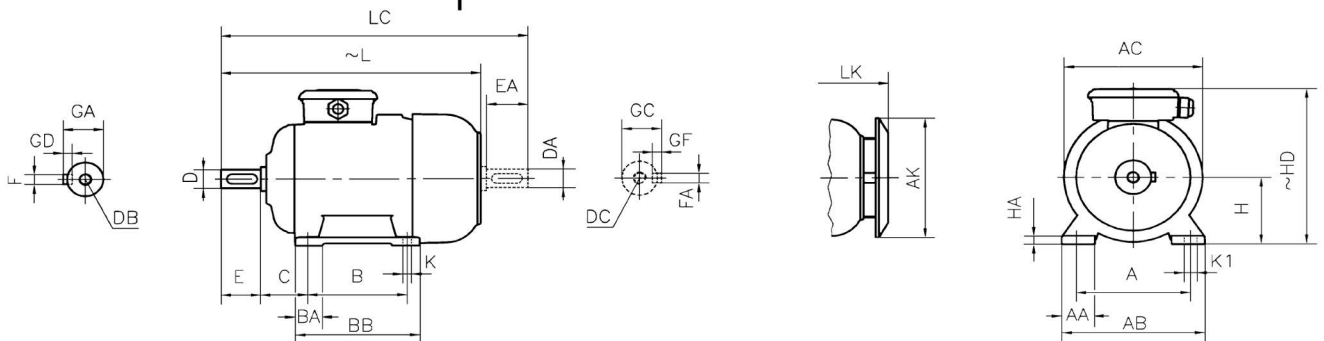

### DIMENSIONS

Dimensions of foot mounted motors for mounting arrangement : B3, B6, B7, B8, B15, V5, V6

H	HD	HA	A	AA	AB	ØAC	ØAK	K	K1	B	B'	BA	BA'	BB	L	LC	LK	C	E	EA	DB	DC	ØDA	GA	GC	FxGD	FAXGF
180	421	24	279	68	354	348	303	15	-	279	-	62	-	329	695	811	752	121	110	M16	48	51.5	14X9				

\* Efficiencies are calculated according to indirect method where the additional load losses are determined from exact measurements at different load points.

contact:

Mob:00201022621584/00201092425789

Email:info@andalos-trading.com

website:www.andalos-trading.com

Egypt-Giza-of October City

Lelat Alqader-Almaged Center