

AGM 180 M 4

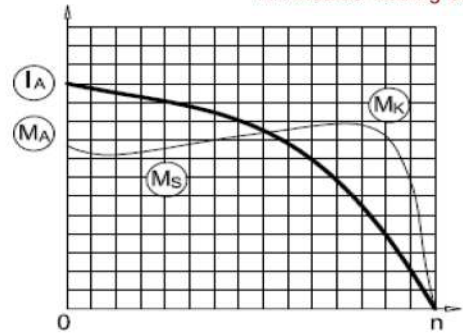

3-Phase 400 V (Δ) 50 Hz

- Duty Type : S1
- Degree of protection : IP 55 (TEFC)
- Insulation class : F (155 °C)
- Temp rise : Class B (80K)
- Mounting Design : B3



ELECTRICAL DESIGN

Direct On Line

Rated output (kW) : 18,5	Locked rotor Current – Ia (A) : 266
Speed (rpm) : 1470	Ia / In : 7,7
Rated current (A) : 34,5	Locked rotor Torque – Ma (Nm) : 384
	Ma / Mn : 3,2
Y / Δ Starting	
Torque – Mn (Nm) : 120	Locked rotor Current – Ia (A) : 86
Cos φ : 0,85	Ia / In : 2,5
Efficiency % : 91,3 (4/4) / 91,4 (3/4) / 90,4 (1/2)	Locked rotor Torque – Ma (Nm) : 120
	Ma / Mn : 1,0
Moment of inertia J (kgm) ² : 0,13	Breakdown Torque – Mk (Nm) : 408
	Mk / Mn : 3,4

MECHANICAL DESIGN

- Frame : Aluminium
- End shields : Aluminium
- Cooling fan : Plastic
- Terminal box : Plastic
- Cable gland : Pg 29
- No of cable glands : 2

Bearing Arrangement

	Drive End	Non Drive End
Standard design	6310 ZZ C3	6210 ZZ C3
Reinforced design	NU 310 E	6310 C3
Noise Level (dB-A) : 64		
Paint : RAL 7031- Grey		
Approximate weight (kg) : 145		

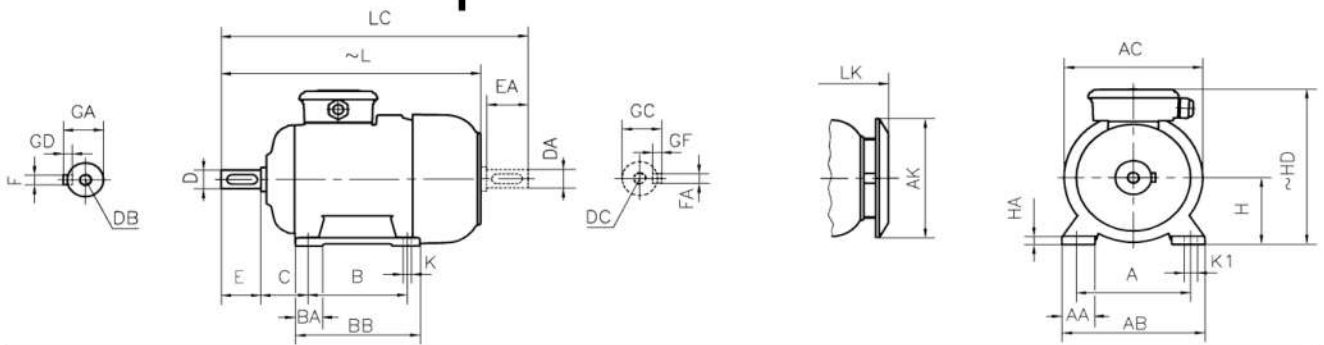

DIMENSIONS

Dimensions of foot mounted motors for mounting arrangement : B3, B6, B7, B8, B15, V5, V6

H	HD	HA	A	AA	AB	ØAC	ØAK	K	K1	B	B'	BA	BA'	BB	L	LC	LK	C	E	DB	ØD	GA	FxGD
~	~																	EA	DC	ØDA	GC	GC	FAXGF
180	421	24	279	68	354	348	303	15	19	241	279	57	95	320	657	773	714	121	110	M16	48	51,5	14X9

* Efficiencies are calculated according to indirect method where the additional load losses are determined from exact measurements at different load points.

contact:

Mob:00201022621584/00201092425789

Email:info@andalos-trading.com4

website:www.andalos-trading.com

Egypt-Giza-of October City

Lelat Alqader-Almaged Center