

# AGM160 M 4

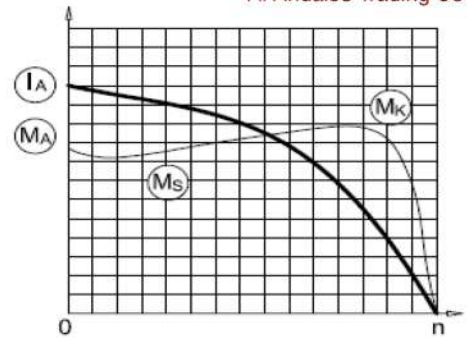

3-Phase 400 V (Δ) 50 Hz

- Duty Type : S1
- Degree of protection : IP 55 ( TEFC )
- Insulation class : F ( 155 °C )
- Temp rise : Class B ( 80K )
- Mounting Design : B3



## ELECTRICAL DESIGN

### Direct On Line

Rated output (kW) : 11	Locked rotor Current – Ia (A) : 145
	Ia / In : 6.9
Speed (rpm) : 1470	Locked rotor Torque – Ma (Nm) : 172
	Ma / Mn : 2.4
Rated current (A) : 21	
Torque – Mn (Nm) : 71.5	
Cos φ : 0.83	
Efficiency % : 91.4    91.3    91	

### Y / Δ Starting

Moment of inertia J (kgm) <sup>2</sup> : 0.072	Locked rotor Current – Ia (A) : 46
	Ia / In : 2.2
	Locked rotor Torque – Ma (Nm) : 57
	Ma / Mn : 0.8
	Breakdown Torque – Mk (Nm) : 222
	Mk / Mn : 3.1

## MECHANICAL DESIGN

- Frame : Aluminium
- End shields : Aluminium
- Cooling fan : Plastic
- Terminal box : Plastic
- Cable gland : Pg 29
- No of cable glands : 2

### Bearing Arrangement

	Drive End	Non Drive End
Standard design	6309 ZZ C3	6209 ZZ C3
Reinforced design	NU 309 E	6309 C3
Noise Level (dB-A)	: 62	
Paint	: RAL 7031- Grey	
Approximate weight (kg)	: 90	

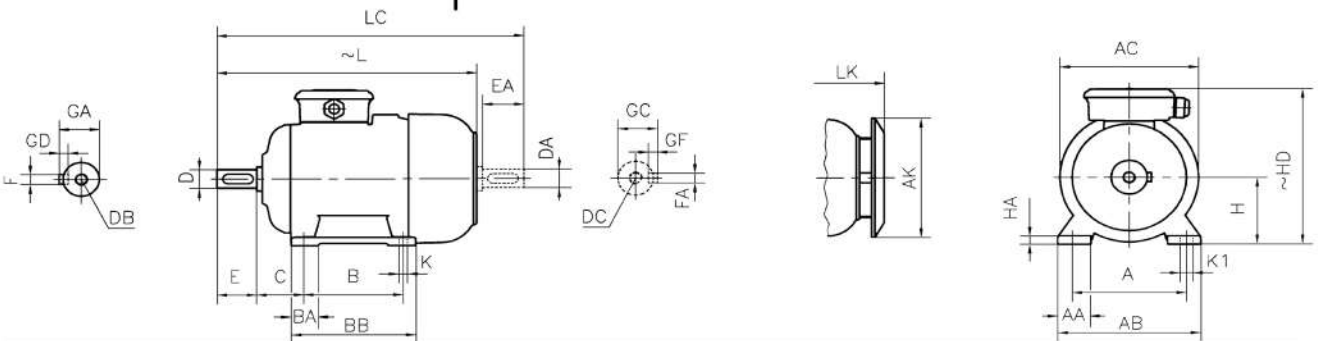

### DIMENSIONS

Dimensions of foot mounted motors for mounting arrangement : B3, B6, B7, B8, B15, V5, V6

H	HD	HA	A	AA	AB	ØAC	ØAK	K	K1	B	B'	BA	BA'	BB	L	LC	LK	C	E	EA	DB	DC	ØD	ØDA	GA	GC	FxGD	FAXGF
160	380	21.5	254	60	312	310	303	15	19	210	254	60	104	304	600	716	657	108	110	M16	M16	42	42	45	45	12X8	12X8	

\* Efficiencies are calculated according to indirect method where the additional load losses are determined from exact measurements at different load points.

contact:

Mob:00201022621584/00201092425789

Email:info@andalos-trading.com

website:www.andalos-trading.com

Egypt-Giza-of October City

Lelat Alqader-Almaged Center