

AGM112 M 4

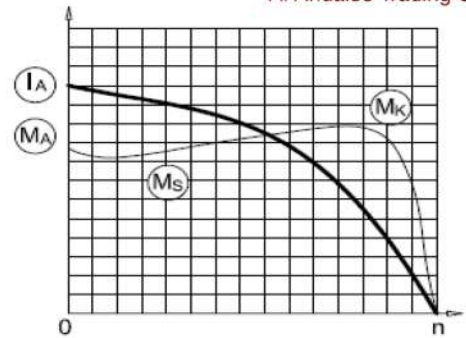

3-Phase 400 V (Δ) 50 Hz

- Duty Type : S1
- Degree of protection : IP 55 (TEFC)
- Insulation class : F (155 °C)
- Temp rise : Class B (80K)
- Mounting Design : B3



ELECTRICAL DESIGN

Direct On Line

Rated output (kW) : 4	Locked rotor Current – Ia (A) : 57
	Ia / In : 7.2
Speed (rpm) : 1460	Locked rotor Torque – Ma (Nm) : 79
	Ma / Mn : 3.0
Rated current (A) : 7.9	
Y / Δ Starting	
Torque – Mn (Nm) : 26.2	Locked rotor Current – Ia (A) : 19
	Ia / In : 2.4
Cos φ : 0.82	Locked rotor Torque – Ma (Nm) : 26
	Ma / Mn : 1.0
Efficiency % : 88.6 88.5 88	Breakdown Torque – Mk (Nm) : 94
	Mk / Mn : 3.6
Moment of inertia J (kgm) ² : 0.012	

MECHANICAL DESIGN

- Frame : Aluminium
- End shields : Aluminium
- Cooling fan : Plastic
- Terminal box : Plastic
- Cable gland : Pg 16
- No of cable glands : 2

Bearing Arrangement

	Drive End	Non Drive End
Standard design	6206 ZZ	6206 ZZ
Reinforced design	-	-
Noise Level (dB-A)	: 52	
Paint	: RAL 7031- Grey	
Approximate weight (kg)	: 36	

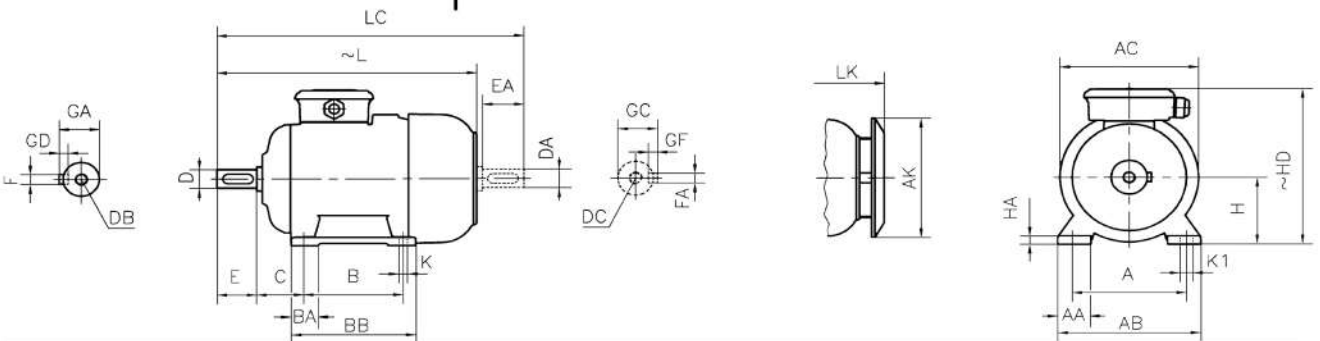

DIMENSIONS

Dimensions of foot mounted motors for mounting arrangement : B3, B6, B7, B8, B15, V5, V6

H	HD	HA	A	AA	AB	ØAC	ØAK	K	K1	B	B'	BA	BA'	BB	L	LC	LK	C	E	DB	ØD	GA	FxGD
	~														~		~		EA	DC	ØDA	GC	FAXGF
112	257	13	190	47	230	218	189	12	18	140	-	39	-	175	421	487	458	70	60	M10	28	31	8X7

* Efficiencies are calculated according to indirect method where the additional load losses are determined from exact measurements at different load points.

contact:

Mob:00201022621584/00201092425789

Email:info@andalos-trading.com

website:www.andalos-trading.com

Egypt-Giza-of October City

Lelat Alqader-Almaged Center