

AGM 56 4b

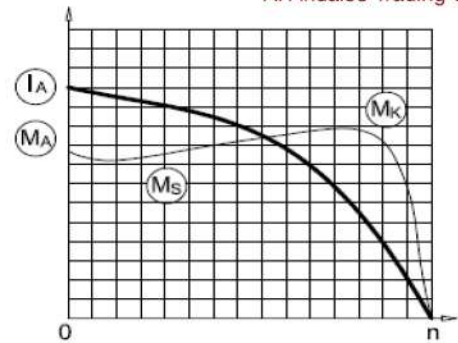

3-Phase 230/400 V 50 Hz

- Duty Type : S1
- Degree of protection : IP 55 (TEFC)
- Insulation class : F (155 °C)
- Temp rise : Class B (80K)
- Mounting Design : B3



ELECTRICAL DESIGN

Direct On Line

- Rated output (kW) : 0.09
- Speed (rpm) : 1375
- Rated current (A) : 0.36
- Torque – Mn (Nm) : 0.63
- Cos φ : 0.58
- Efficiency % : 62.5 (4/4), 62.3 (3/4), 55.1 (1/2)
- Moment of inertia J (kgm)² : 0.00012

- Locked rotor Current – Ia (A) : 1
- Ia / In : 3.1
- Locked rotor Torque – Ma (Nm) : 1
- Ma / Mn : 2.2

Y / Δ Starting

- Locked rotor Current – Ia (A) : -
- Ia / In : -
- Locked rotor Torque – Ma (Nm) : -
- Ma / Mn : -
- Breakdown Torque – Mk (Nm) : 2
- Mk / Mn : 2.4

MECHANICAL DESIGN

- Frame : Aluminium
- End shields : Aluminium
- Cooling fan : Plastic
- Terminal box : Plastic
- Cable gland : Pg 11
- No of cable glands : 1

Bearing Arrangement

- Standard design : 6200 ZZ
- Reinforced design : -
- Noise Level (dB-A) : 42
- Paint : RAL 7031- Grey
- Approximate weight (kg) : 2.8

	Drive End	Non Drive End
Standard design	6200 ZZ	6200 ZZ
Reinforced design	-	-

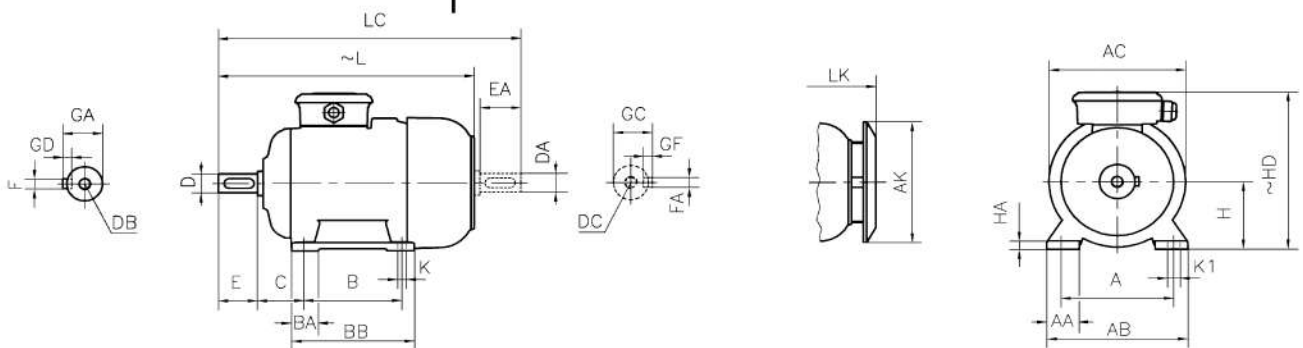

DIMENSIONS

Dimensions of foot mounted motors for mounting arrangement : B3, B6, B7, B8, B15, V5, V6

H	HD	HA	A	AA	AB	∅AC	∅AK	K	K1	B	B'	BA	BA'	BB	L	LC	LK	C	E	DB	∅D	GA	FxGD
56	152	9	90	28	112	105	-	5.8	9	71	-	24	-	87	161	185	-	36	20	M4	9	10.2	3X3
	~														~				EA	DC	∅DA	GC	FAXGF

* Efficiencies are calculated according to indirect method where the additional load losses are determined from exact measurements at different load points.

contact:

Mob:00201022621584/00201092425789

Email:andaloseg@gmail.com

website:www.andalos-trading.com

Egypt-Giza-of October City

Lelat Alqader-Almaged Center