



# BMFX

## ROUND DUCT TYPE FANS / Mixed Flow

### Device Components and Material Properties

Duct type mixed flow fans, ST extension models are standard. Body and fan made of plastic. BMFX 250 and 315 models are also available with electrostatic painted sheet version. Thanks to the body design, it is possible to disassemble and install the fan and motor without being disassembled.

### Fan Structure

Mixed flow fans consist of a combination of working principles of axial and casing centrifugal fans. These fans draw air in and out more linearly. This makes the system more efficient and reduces motor power.

### Benefits

They are highly efficient due to the mixed flow propeller. They work pretty quietly. When the fan is connected to the duct, the motor part can be easily removed and installed. They can work in double cycle. The suction and discharge nozzles are compatible with the duct diameters and can be disconnected by clamp.

### Speed Control

Optional control devices can be provided.  
\* Double speed motor \* Speed control with linear voltage regulator (see BSC accessory)

### Usage Areas

It is used for return air, supply air or general ventilation applications where low noise level and high efficiency are important. It should be used with oil holding filter in oily environments.

## Technical Drawing and Tables

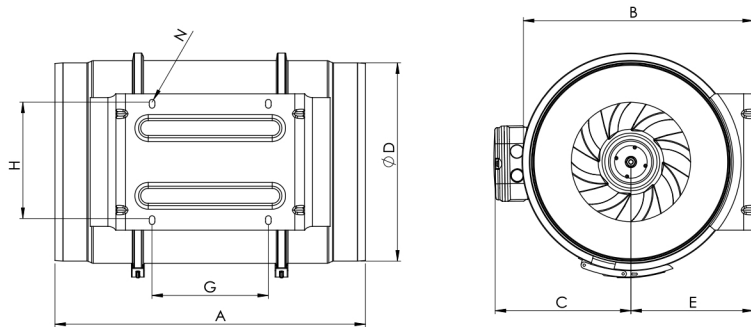

TYPE	A	B	C	D	E	G	H	N
BMFX-100	303	188	115	97	100	80	60	5,5
BMFX-125	258	188	115	123	100	80	60	5,5
BMFX-150	320	212	127	147	112	80	60	5,5
BMFX-200	302	232,5	141	197	124	100	94	5,5
BMFX-250	386	291	192	248	155	145	140	7X4
BMFX-315	450	356	224	312	188	182	178	7X4
BMFX-250-P	383	286	173	247	151	150	173	7X4
BMFX-315-P	446	357	216	312	187	181	216	7X4

Dimensions are in (mm)

TYPE	A	ØB	ØD	E	F	G	X	C	ØH
BMFX-ST100	460	204	23	81	248	333	222	93	98
BMFX-ST125	460	204	23	81	248	333	222		

Dimensions are in (mm)

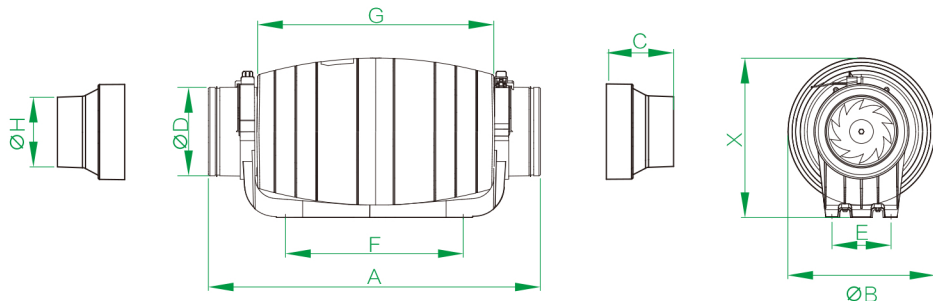

contact:

Mob:00201022621584/00201092425789

Email:info@andalos-trading.com

website:www.andalos-trading.com

Egypt-Giza-of October City

Lelat Alqader-Almaged Center