



## EF

### AXIAL BATHROOM FANS / *Decoratife*

The front panel is thin and tight. This feature provides a robust mounting design. It is silent and corrosion resistant. Long life of the motor against environmental factors. Thermal protection.

Can be mounted on glass and wall. It is used for small volume spaces, bath and toilet ventilation.

#### Technical Drawing and Tables

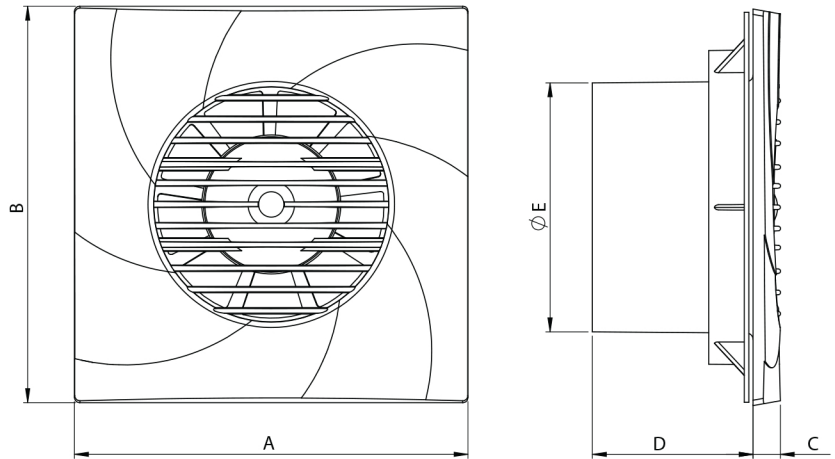

TYPE	A	B	C	D	E
EF 1009	160	160	12	70	97,5
EF 1219	188	188	14	76	118
EF 1530	208	208	14	118	145

Dimensions are in (mm)

TYPE	VOLTAGE	FREQUENCY	POWER	CURRENT	CAPACITOR	SPEED	AIR FLOW	SOUND PRESSURE	INSULATION CLASS	PROTECTION CLASS	WEIGHT	PIECES IN BOX
	V	Hz	W	(A)	( $\mu$ F)	r.p.m	m <sup>3</sup> /h	dB(A)	Ins.cl.	IP	kg	AD
EF 1009	230	50/60	13	0,09	-	2600	100	40	B	20	0,5	24
EF 1219	230	50/60	14	0,09	-	2400	200	41	B	20	0,55	20
EF 1530	230	50/60	21	0,13	-	2000	300	43	B	20	0,71	16

Sound Level Measured from 3m distance in room condition.

contact:

Mob:00201022621584/00201092425789

Email:info@andalos-trading.com

website:www.andalos-trading.com

Egypt-Giza-of October City  
Lelat Alqader-Almaged Center